

"RACE TRACK ROAD SUBDIVISION"

SECTION 3, TWP. 49 S., RGE. 42 E.
BROWARD COUNTY-FLORIDA

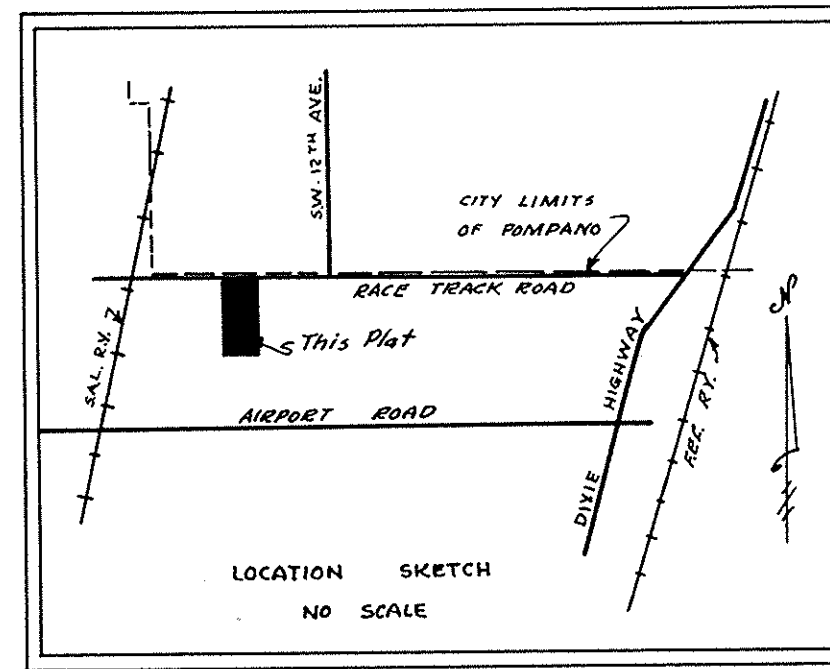

McLAUGHLIN ENGINEERING Co.
400 N. E. 3RD AVENUE
FORT LAUDERDALE FLORIDA

SCALE IN FEET
0 10 20 30 40 50 75 100 150
1" = 50'

JANUARY 1958

NOTES

All Radii Are 25' Unless Otherwise Noted.
Denotes PERMANENT REFERENCE MONUMENTS.
Lot Dimensions Are To Tangent Intersections Unless
Otherwise Indicated.

MORTGAGE HOLDERS

APPROVAL

WE, the undersigned, OWNERS and HOLDERS of a MORTGAGE on the above described PROPERTY, hereby APPROVE and ACCEPT this PLAT.

Marion D. Salmons
Pauline C. Salmons

DESCRIPTION

The WEST 1/2 of the N.E. 1/4 of GOVERNMENT LOT 8, SECTION 3, TOWNSHIP 49 S., RANGE 42 E., BROWARD COUNTY, FLORIDA.

DEDICATION

STATE OF FLORIDA }
COUNTY OF BROWARD }
KNOW ALL MEN BY THESE PRESENTS: That ROBERT I. SMITH and DARLEEN M. SMITH, his wife; owners of the lands described and shown as included in this PLAT have caused said lands to be subdivided in the manner shown. All THOROUGHFARES are DEDICATED to the perpetual use of the PUBLIC in fee simple. All EASEMENTS are DEDICATED to the perpetual use of the PUBLIC for purposes as indicated.

IN WITNESS WHEREOF: WE have hereunto set our HANDS and affixed our SEALS.

Witness: *Marion D. Salmons* *Robert I. Smith* (SEAL)
Witness: *Mary Richards* *Darleen M. Smith* (SEAL)

ACKNOWLEDGEMENT

STATE OF FLORIDA }
COUNTY OF BROWARD }
I HEREBY CERTIFY: That on this day personally appeared before me, an OFFICER duly authorized to administer OATHS and take ACKNOWLEDGEMENTS, ROBERT I. SMITH and DARLEEN M. SMITH, his wife; to me well known to be the individuals described in, and who executed the foregoing DEDICATION, and they acknowledged before me that they executed the same freely and voluntarily for the uses and purposes therein expressed.

WITNESS: My HAND and OFFICIAL SEAL at FORT LAUDERDALE, in the COUNTY of BROWARD, STATE OF FLORIDA, this 4TH day of March, 1958.

R. W. Schoen
NOTARY PUBLIC STATE OF FLORIDA
My Commission Expires: Feb. 20, 1959

CIRCUIT COURT CLERK'S CERTIFICATE

STATE OF FLORIDA }
COUNTY OF BROWARD }
I HEREBY CERTIFY: That this PLAT complies with the provisions of an ACT TO REGULATE THE MAKING OF SURVEYS AND FILING FOR RECORD OF MAPS AND PLATS IN THE STATE OF FLORIDA, approved by the GOVERNOR, June 11th 1925.

FRANK H. MARKS
CLERK OF THE CIRCUIT COURT

BY: *T. B. Collins* DEPUTY CLERK

This INSTRUMENT filed for RECORD this 23rd day of May, 1958, and RECORDED in BOOK 47, of PLATS, at PAGE 10, RECORD VERIFIED.

FRANK H. MARKS
CLERK OF THE CIRCUIT COURT

BY: *Madeline Parkhurst* DEPUTY CLERK

ENGINEER'S CERTIFICATE

STATE OF FLORIDA }
COUNTY OF BROWARD }
WE, hereby CERTIFY: That this PLAT is a true and correct representation of a survey made by us, and that PERMANENT REFERENCE MONUMENTS have been set as indicated. Dated at FORT LAUDERDALE, FLORIDA, this 27th day of February, 1958.

McLAUGHLIN ENGINEERING Co.

BY: *J. W. M. Langley*
REG. ENGR. NO. 11113 REG. LAND SURVEYOR NO. 105, STATE OF FLORIDA

COUNTY ENGINEER

APPROVED FOR RECORD: *William D. Rawls* DIRECTOR

BROWARD COUNTY, FLORIDA ZONING DEPT.
MAR 5 1958